

| SCHEDULE OF DOORS & WINDOWS |       |        |      |        |  |          |                    |        |      |                  |               |
|-----------------------------|-------|--------|------|--------|--|----------|--------------------|--------|------|------------------|---------------|
| DOORS:                      |       |        |      |        |  | WINDOWS: |                    |        |      |                  |               |
| MKD                         | WIDTH | HEIGHT | SILL | LINTEL |  | MKD      | WIDTH              | HEIGHT | SILL | LINTEL           |               |
| SWT                         | 1500  | 2050   | 150  | 2200   |  | WT       | 1500               | 1800   | 450  | 2200             |               |
| SWP                         | 1500  | 2050   | 150  | 2200   |  | WE       | 2200               | 1800   | 450  | 2200             |               |
| US                          | 900   | 2200   | 00   | 2200   |  | WEC      | 1200               | 1800   | 500  | 2200             |               |
| DV                          | 900   | 2200   | 00   | 2200   |  | WSA      | 800                | 1800   | 900  | 2200             |               |
| D1                          | 1100  | 2200   | 00   | 2200   |  | WA       | 800                | 1800   | 400  | 2200             |               |
| D2                          | 750   | 2200   | 00   | 2200   |  | WE       | 900                | 1900   | 2200 |                  |               |
| SD                          | 2400  | 2200   | 00   | 2200   |  | WA*      | 450                | 1450   | 400  | 2200             |               |
| SD1                         | 2100  | 2200   | 00   | 2200   |  | SW       |                    |        |      | STAIRCASE WINDOW | Air Elevation |
| SD2                         | 1800  | 2200   | 00   | 2200   |  | Gz.2     | GLAZING            |        |      |                  | Air Elevation |
| SD3                         | 1500  | 2200   | 00   | 2200   |  | Gz.1     |                    |        | 1800 |                  | 400           |
| SD4                         | 1350  | 2200   | 00   | 2200   |  | Vw       | Ventilation Window |        |      |                  | Above Sill    |
| SD5                         | 1350  | 2200   | 00   | 2200   |  |          |                    |        |      |                  |               |
| FD                          | 1200  | 2200   | 00   | 2200   |  |          |                    |        |      |                  |               |
| FD1                         | 1200  | 2200   | 00   | 2200   |  |          |                    |        |      |                  |               |
| FD2                         | 750   | 2200   | 00   | 2200   |  |          |                    |        |      |                  |               |

- NOTE:
1. ALL DIMENSIONS ARE IN MM. UNLESS OTHERWISE MENTIONED.
  2. ALL EXTERNAL WALLS ARE 160 THK & INTERNAL WALLS ARE 125 THK.
  3. ALL ELEVATION PROJECTIONS ARE 500 MM. PROJECTED.
  4. DEPTH OF UNDERGROUND WATER RESERVOIR SHOULD NOT EXCEED THE DEPTH OF FOUNDATION.
  5. ANY DISCREPANCY IN SCALE, THE WRITTEN DIMENSION SHALL GOVERN.
  6. FOR SPECIFICATION OF MATERIALS & WORKMANSHIP N.B.C. 2016 TO BE FOLLOWED.
  7. OPEN TERRACE WITH LAKE TERRACING OF RATIO 2:2.7.
  8. FLY ASH AND FLY ASH BASED MATERIAL WILL BE USED IN THE PROJECT.
  9. SOLAR ENERGY OF 2% OF THE CONNECTED LOAD WILL BE USED IN THIS PROJECT.
  10. FSR NO. - FSR/21186240630000445
  11. AM MEMO NO. KOLK/EAST/08/1022/688906

CERTIFICATE OF THE OWNER

CERTIFIED THAT I HAVE GONE THROUGH THE BUILDING RULES OF WEST BENGAL MUNICIPAL BUILDING RULES, 2007 AND ITS AMENDMENT & ALSO UNDERTAKE TO ABIDE BY THOSE RULES DURING & AFTER THE CONSTRUCTION OF THE BUILDING.

SRIJAN RESIDENCY LLP  
 38/1A, ELGIN ROAD  
 KOLKATA - 700020  
 SIGNATURE OF OWNER

CERTIFIED THAT THE STRUCTURAL DRAWINGS AND DESIGN OF BOTH THE FOUNDATION AND SUPERSTRUCTURE OF THE BUILDING/BUILDINGS HAS BEEN MADE CONSIDERING THE SOIL TEST REPORT AS PER THESE RULES AND REGULATIONS MADE UNDER THE ACT AND ALSO VERIFYING ALL POSSIBLE LOADS, SEISMIC LOADS AND THE MOMENTS GENERATED BY THE PROPOSED STRUCTURE AS PER THE BUREAU OF INDIAN STANDARDS AND NATIONAL BUILDING CODE OF INDIA AND CERTIFIED THAT IT IS SAFE AND STABLE IN ALL RESPECT AND THESE PROVISIONS SHALL BE ADHERED TO DURING THE CONSTRUCTION.

UPPAL SANTHA  
 UPPAL SANTHA  
 S.T.C. (M.C.E. STRUCT.)  
 F.I.E. 1722901  
 INDIA Council Structural Engineer  
 STRV/INDIA/15/100009  
 SIGNATURE OF STRUCTURAL REVIEWER

ANKIT AGARWAL  
 B.E. CIVIL, M.E. ESTD  
 G.I. INDIA, M.STRUC. ENGINEER  
 Membership No. 07830858  
 INDIA EMPLOYED STRUCTURAL ENGINEER  
 STRV/INDIA/15/100015  
 SIGNATURE OF STRUCTURAL ENGINEER

IT IS CERTIFIED THAT THE COMPREHENSIVE GEO-TECHNICAL REPORT ON SOIL INVESTIGATION HAS BEEN PREPARED BY ME FOR DESIGN AND CALCULATION OF THE FOUNDATION BY ANALYZING THE SOIL SAMPLE FOR ESTIMATING THE BEARING CAPACITY OF THE SOIL ON WHICH FOUNDATION OF THE STRUCTURE WILL BE CONSTRUCTED.

I SHALL ALSO CHECK THE NATURE OF THE SOIL AFTER EXCAVATION AT SITE SO THAT FOUNDATION IS EXTENDED UP TO APPROPRIATE DEPTH THAT HAS BEEN PROPOSED IN THE GEO-TECHNICAL REPORT.

JISHU PAL  
 M.Tech (Civil), M.E. (Structure)  
 A.M.C. No. 19/04/2019  
 27/03/2019/2019/04/19/04/19  
 ENROLLMENT NO- GTER/INDIA/10/00049  
 Signature of Geotechnical Engineer

CERTIFICATE OF THE ARCHITECT

I CERTIFY THAT ALL THE ARCHITECTURAL DRAWINGS OF THE PROJECT AT MAJESTY PROPERTY PVT LTD. (REGD. OFFICE NO. 1, 2, 3 & 5, 10/19, 12/13, 14, 15, 16, 17, 18, 19, 21, 22, 23, 24, 25, 26, 27, 28, 29, 30, 31, 32, 33, 34, 35, 36, 37, 38, 39, 40, 41, 42, 43, 44, 45, 46, 47, 48, 49, 50, 51, 52, 53, 54, 55, 56, 57, 58, 59, 60, 61, 62, 63, 64, 65, 66, 67, 68, 69, 70, 71, 72, 73, 74, 75, 76, 77, 78, 79, 80, 81, 82, 83, 84, 85, 86, 87, 88, 89, 90, 91, 92, 93, 94, 95, 96, 97, 98, 99, 100) HAS BEEN PREPARED BY ME IN CONFORMANCE WITH THE BUILDING ACT, 1956 AND THE BUILDING RULES, 2007 AND ALSO CERTIFY THAT THE PLANS AND DRAWINGS PREPARED BY ME COMPLY WITH ALL PROVISIONS REGARDING THE PROTECTION AS PER THE PREVALENT NATIONAL BUILDING CODE OF INDIA. I SHALL BE HELD RESPONSIBLE FOR ANY DISCREPANCY INFORMATION IS FURNISHED BY ME OR ANY VIOLATION OR PROVISIONS OF THESE RULES OR THE PREVALENT NATIONAL BUILDING CODE IS FOUND IN ANY OF THE DRAWINGS AND DOCUMENTS SIGNED BY ME AND SUBMITTED TO THE SANCTIONING AUTHORITY FOR GRANTING SANCTION.

KAMAL KUMAR PERIHAL  
 CA-85-18679  
 SIGNATURE OF ARCHITECT  
 KAMAL KUMAR PERIHAL  
 ENROLLMENT NO- ACHR/INDIA/10/00016  
 C.O.A REGISTRATION NO- CA-85-18679

ARPAN DAS GUPTA  
 B. Arch (TU), M. TRP, (IIBST)  
 AIA, A. TP  
 ARCHITECT, TOWN PLANNER  
 Imp. No. - TRER/NKDA/20/00003  
 Signature of Town Planner  
 ARPAN DASGUPTA  
 ENROLLMENT NO- TPER/INDIA/20/00003

PROJECT :

PROPOSED G+18(TOWER B,E,G) G+19(TOWER A,C,D,F) STORIED RESIDENTIAL BUILDING MAUZA-KALABERIA, JL NO.30, LR DAG NO : 1, 2, 3, 4, 5, 11(P), 12, 13, 14, 15, 16, 17, 18, 19, 20, 21, 22, 23, 24, 25, 26, 27(P), 28(P), 42, 43(P), 44(P), 74, 79, 80 & MAUZA BHATENDA, JL NO.28, LR DAG NO: 485,486,488, PS-RAJARHAT, RAJARHAT-BISNUPUR 1 NO GRAM PANCHAYAT, NORTH 24 PGS, PIN - 700135

CONTENTS :

BLOCK 2 -SECOND FLOOR PODIUM PLAN

|                    |                           |          |      |
|--------------------|---------------------------|----------|------|
| SUBMISSION DRAWING | SHEET NO. - 13/37         |          |      |
| NORTH              | MA/RAJARHAT/SUB/ARCH/S-13 |          |      |
| REV. DATE          |                           | REV. NO. |      |
| SCALE              | 1:100                     | DEALT    |      |
| DATE               | 09.03.2024                | CHECKED  | M.B. |

ARCHITECT :

MAHESHWARI & ASSOCIATES  
 37A, BAKER ROAD, 2ND FLOOR, ALIPORE,  
 KOLKATA-27  
 TEL. : 65228584, www.architectm.com

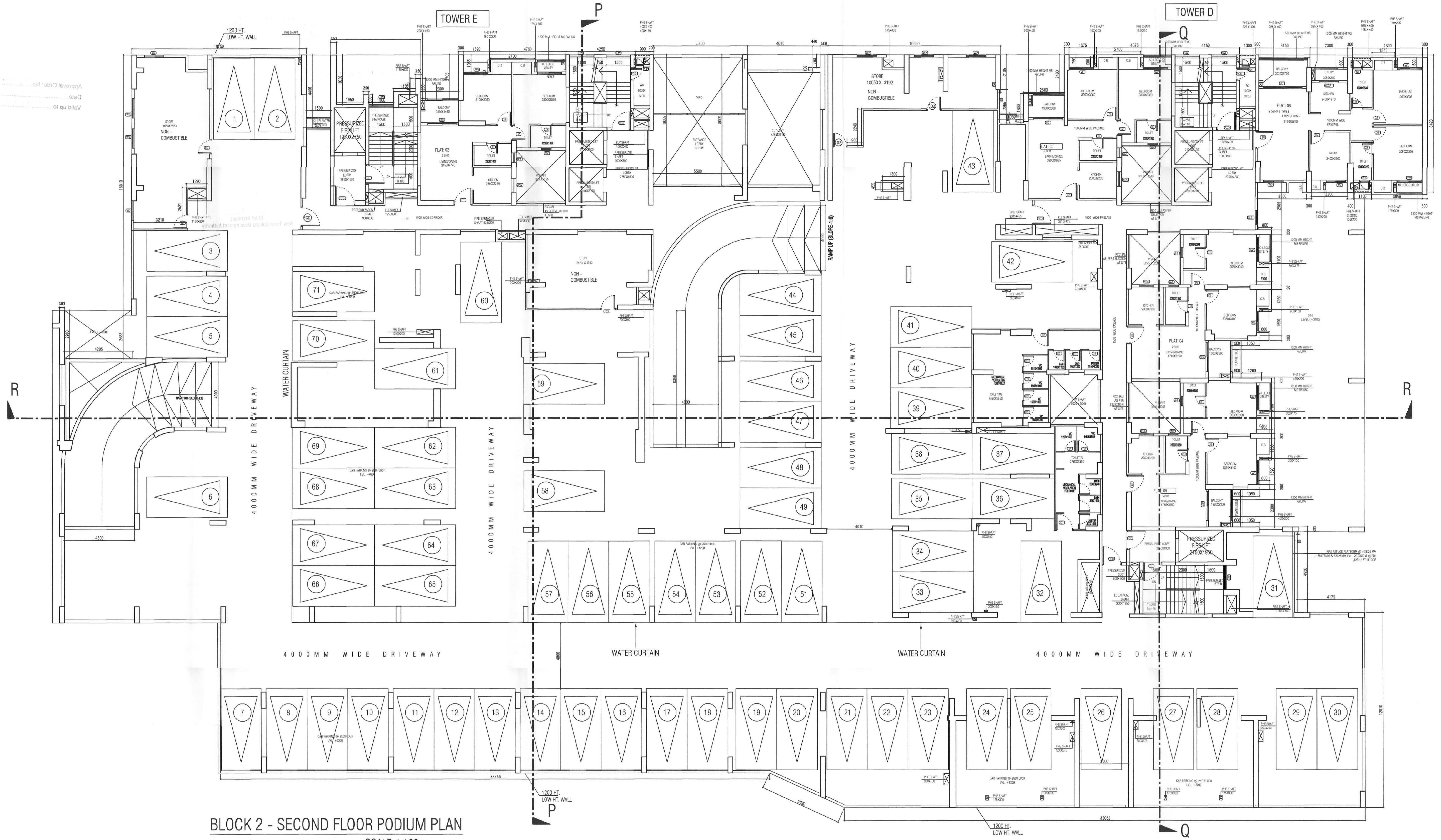

BLOCK 2 - SECOND FLOOR PODIUM PLAN  
 SCALE:1:100

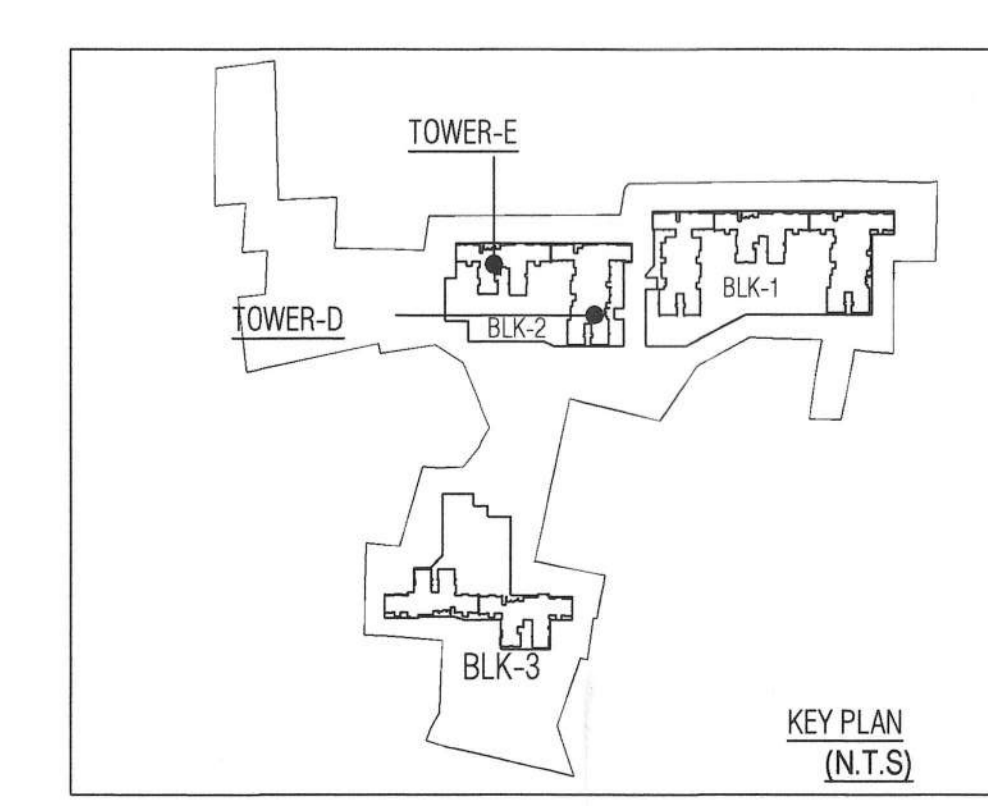

KEY PLAN (N.T.S.)

ARCHITECT: **RAJESH K. CHAKRABORTY**  
 STRUCTURAL ENGINEER: **RAJESH K. CHAKRABORTY**  
 ELECTRICAL ENGINEER: **RAJESH K. CHAKRABORTY**  
 MECHANICAL ENGINEER: **RAJESH K. CHAKRABORTY**  
 CIVIL ENGINEER: **RAJESH K. CHAKRABORTY**

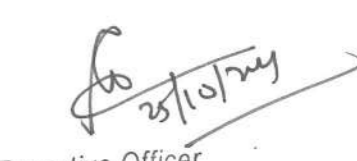
SANCTIONED & APPROVED  
  
 Executive Officer  
 Rajarhat Panchayat Samity  
 Rajarhat, North 24 Parganas

Note: This NOC has been issued on the basis of documents submitted by the applicant and forwarded by the ADE. Executive Officer, North 24 Parganas. It is not intended to be a guarantee of any kind. If there is any material misrepresentation of fact or fraud or any act of suppression of fact in connection with the above project including the concerned land plan, drawings, design etc., then, this NOC shall stand cancelled.

STRUCTURAL DRAWINGS, STRUCTURAL DESIGN CALCULATIONS & SOIL TEST REPORT ARE NOT CHECKED AND LEFT FOR RECORDS ONLY.

NOTE: ALL RECOMMENDATIONS FROM POLLUTION CONTROL BOARD SHOULD BE THOROUGHLY FOLLOWED AT THE TIME OF CONSTRUCTION.

NEW TOWN KOLKATA DEVELOPMENT AUTHORITY  
 Sanction of Building Plan for Residential Purpose

Memo No: **4627/NKDA/EP/202/2023**  
 Date: **01.10.2023**

Building Particulars: No. of floors: 10, No. of units: 100, etc.

Approval Order No. **1641/RPS**  
 Date: **23.10.2023**  
 Valid up to: **24.10.2023**

  
 Assistant Architect  
 New Town Kolkata Development Authority

  
 Chief Architect  
 New Town Kolkata Development Authority



BLOCK 2 - SECOND FLOOR PLAN  
 SCALE: 1/100

(Faint vertical text on the left margin, likely bleed-through from the reverse side of the page)